

AIR VALVE REPAIR KIT #784-92399

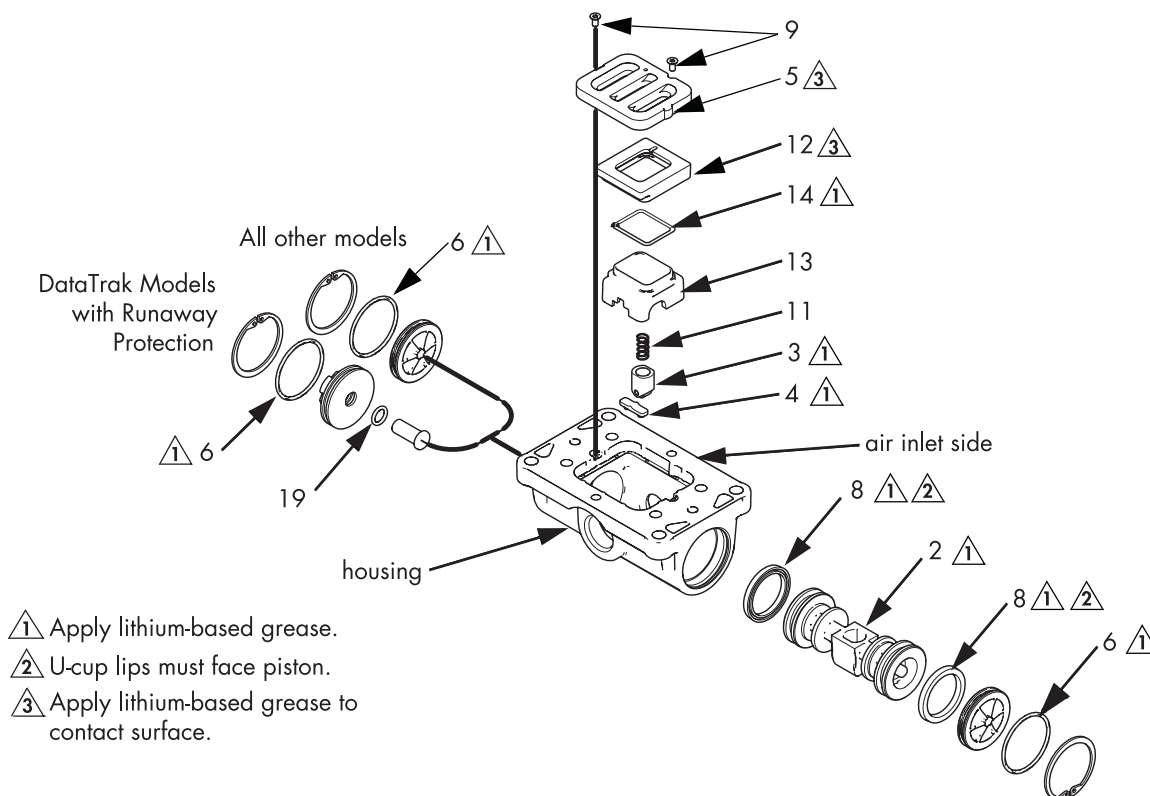

Kit Contents

QTY	ITEM	DESCRIPTION
1	2	Piston
1	3	Detent Piston Assembly
1	4	Detent Cam
1	5	Air Valve Plate
2	6	O-Ring
2	8	U-Cup
2	9	Screw M3
1	11	Detent Spring
1	12	Cup Base
1	13	Cup
1	14	Cup O-Ring
1	19	O-Ring
1		Air Valve Gasket (not shown)
1		Lithium Based Grease (not shown)

Important Safety Instructions

Read all warnings and instructions in the Operation Manual that was provided with your pump. If you have questions, call Graymills Customer Service at 773-248-6825.

See back for more information.



AIR VALVE REPAIR KIT #784-92399

Assembly

NOTE: Apply lithium-based grease whenever instructed to grease.

1. Use all parts in the repair kits, as applicable to your pump. Clean other parts and inspect for damage. Replace as needed.
2. Grease the detent cam (4) and install into housing.
3. Grease the u-cups (8) and install on the piston with lips facing toward the center of the piston.
4. Grease both ends of the piston (2) and install it in the housing, with the flat side toward the cup (13). Be careful not to tear u-cups (8) when sliding piston into housing.
5. **Models with runaway protection solenoid:** Invert the air valve, with the air inlet facing away from you. Grease and install new o-ring (6) on right-side end cap. Grease and install new o-ring (6) and the solenoid release button and o-ring (19) on left-side end cap. Install the end caps into the housing.
6. Install a retaining ring on each end to hold end caps in place.
7. Grease and install the detent assembly (3) into the piston. Install the o-ring (14) on the cup (13). Apply a light film of grease to the outside surface of the o-ring and the inside mating surface of the base (12). Install the cup (13) on the base (12). Install the spring (11) onto protrusion on the cup. Install the cup assembly. Align the small round magnet in the base with the air inlet.
8. Grease the cup side and install the valve plate (5). Align the small hole in the plate with the air inlet. Tighten the screws (9) to hold it in place.