

1" AIR OPERATED DIAPHRAGM PUMPS

NOTE: Figures 1 to 4 are in the order of reassembly, using the new parts in the kit.

- 1 Rounded side must face down.
- 2 Reuse the old screws when possible. Torque to 38 to 43 in-lb (4.3 to 4.9 N-m).

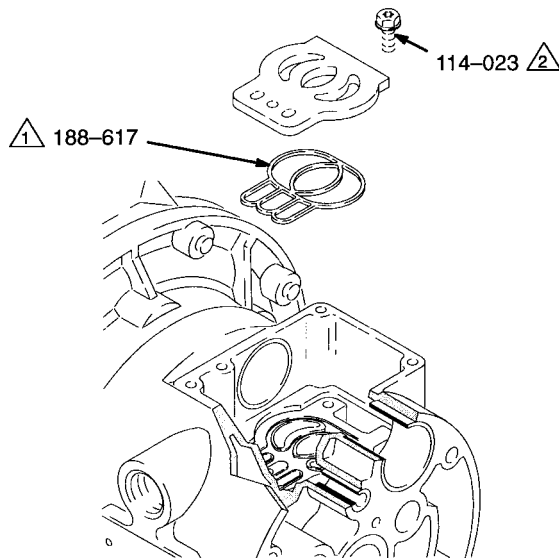

Fig. 1

- 3 Insert narrow end of push pin (N) first.
- 4 Grease.
- 5 Install with lips facing narrow end of piston (P).
- 6 Insert wide end of piston (P) first.

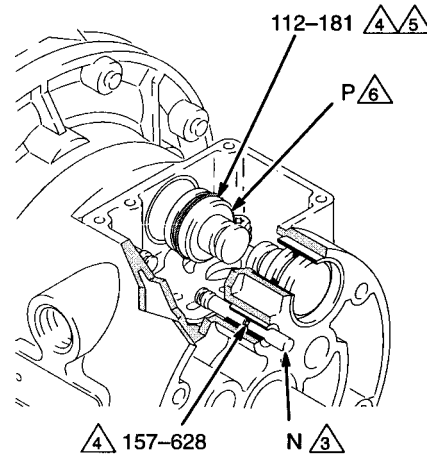

Fig. 2

- 1 See Detail.
- 2 Grease.
- 3 Grease lower face.
- 4 Align with grooves in push pins. Snap in place.
- 5 Align with grooves in pistons. Push in place.

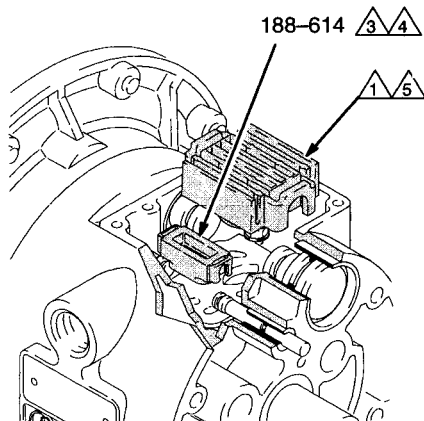
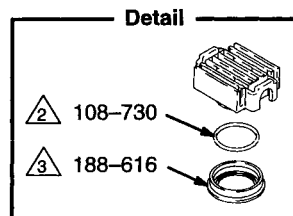

Fig. 3

- 6 Reuse the old screws when possible. Torque to 38 to 43 in-lb (4.3 to 4.9 N-m).

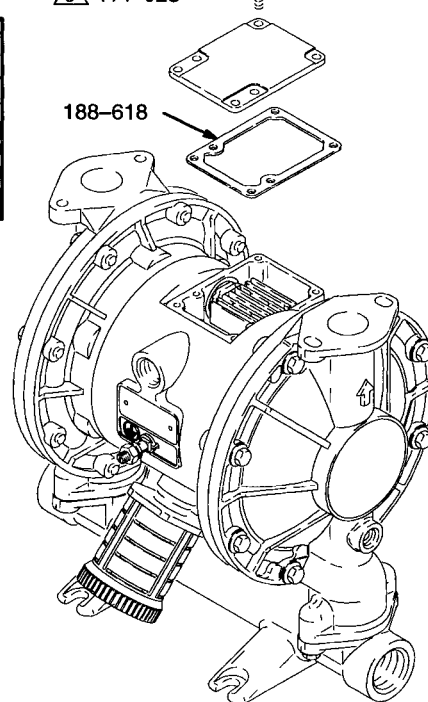

Fig. 4