

1/2" AIR OPERATED DIAPHRAGM PUMPS

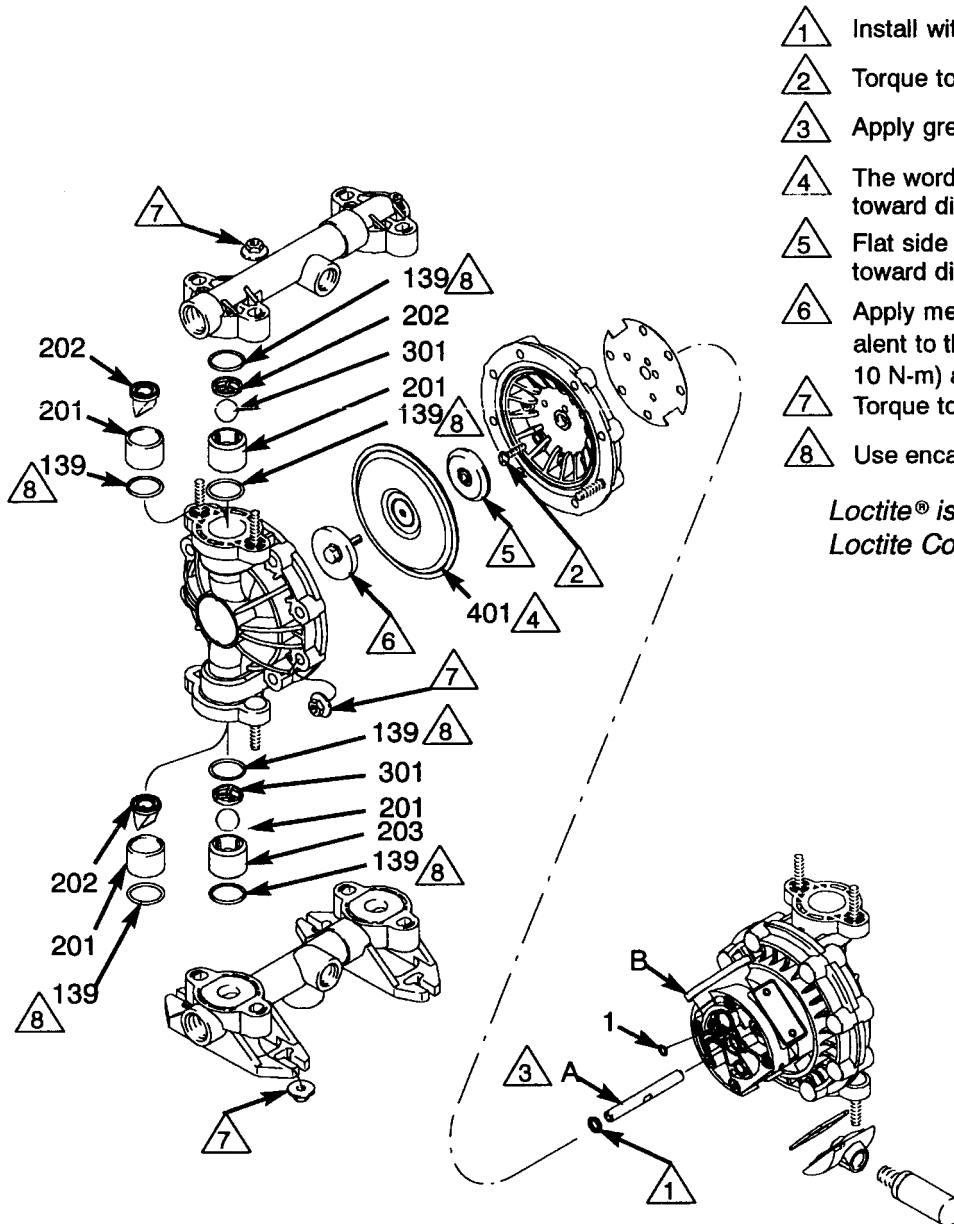

- 1 Install with lips facing out of center housing (B).
- 2 Torque to 25 to 35 in-lb (2.8 to 4.0 N-m).
- 3 Apply grease.
- 4 The words "AIR SIDE" on diaphragm must face toward diaphragm shaft (A).
- 5 Flat side of air-side diaphragm plate must face toward diaphragm shaft (A).
- 6 Apply medium-strength (blue) Loctite® or equivalent to threads, and torque to 80 to 90 in-lb (9 to 10 N-m) at 100 rpm maximum.
- 7 Torque to 80 to 90 in-lb (9 to 10 N-m).
- 8 Use encapsulated o-rings (clear outer part).

Loctite® is a registered trademark of the Loctite Corporation.